

# Planetary Gearhead GP 32 HP $\varnothing 32$ mm, 4.0–8.0 Nm

High Power

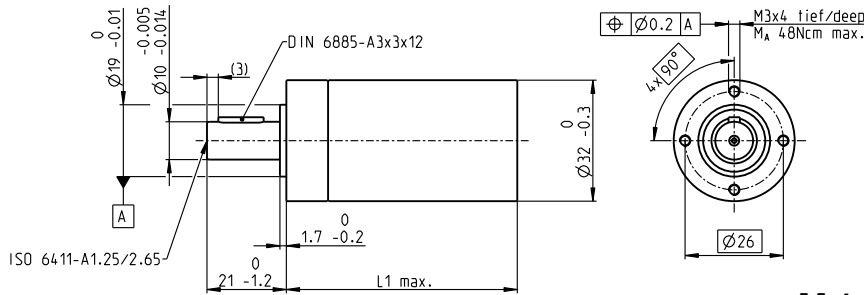

### Technical Data

Planetary Gearhead	straight teeth
Output shaft	stainless steel
Bearing at output	ball bearing
Radial play, 10 mm from flange	max. 0.14 mm
Axial play	max. 0.4 mm
Max. axial load (dynamic)	120 N
Max. force for press fits	120 N
Direction of rotation, drive to output	=
Max. continuous input speed	8000 rpm
Recommended temperature range	-40...+100°C
Number of stages	2 3 4
Max. radial load, 10 mm from flange	200 N 250 N 300 N

M 1:2

- Stock program
- Standard program
- Special program (on request)

### Part Numbers

	320247	326663	326664	326668	326672	324947	324952
<b>Gearhead Data</b>							
1 Reduction	14:1	33:1	51:1	111:1	190:1	456:1	706:1
2 Absolute reduction	676/49	529/16	17576/343	13824/125	456976/2401	89401/196	158171/224
3 Max. motor shaft diameter	mm 6	3	6	4	6	3	3
<b>Part Numbers</b>	326659		326665	326669	324942	324948	324953
1 Reduction	18:1		66:1	123:1	246:1	492:1	762:1
2 Absolute reduction	624/35		16224/245	6877/56	421824/1715	86112/175	19044/25
3 Max. motor shaft diameter	mm 6		6	3	6	6	4
<b>Part Numbers</b>	326660		326666	326670	324944	324949	324954
1 Reduction	21:1		79:1	132:1	295:1	531:1	913:1
2 Absolute reduction	299/14		3887/49	3312/25	101062/343	331776/625	36501/40
3 Max. motor shaft diameter	mm 6		6	4	6	4	3
<b>Part Numbers</b>	326661		326667	326671	324945	324950	
1 Reduction	23:1		86:1	159:1	318:1	589:1	
2 Absolute reduction	576/25		14976/175	1587/10	389376/1225	20631/35	
3 Max. motor shaft diameter	mm 4		6	3	6	6	
<b>Part Numbers</b>	326662		320297		324946	324951	
1 Reduction	28:1		103:1		411:1	636:1	
2 Absolute reduction	138/5		3588/35		359424/875	79488/125	
3 Max. motor shaft diameter	mm 4		6		6	4	
4 Number of stages	2	2	3	3	4	4	4
5 Max. continuous torque	Nm 4	4	8	8	8	8	8
6 Max. intermittent torque at gear output	Nm 6	6	12	12	12	12	12
7 Max. efficiency	% 75	75	70	70	60	60	60
8 Weight	g 178	178	213	213	249	249	249
9 Average backlash no load	° 0.8	0.8	1.0	1.0	1.0	1.0	1.0
10 Mass inertia	gcm <sup>2</sup> 1.6	0.5	1.5	0.7	1.5	1.5	0.7
11 Gearhead length L1	mm 48.3	48.3	55.0	55.0	61.7	61.7	61.7



### maxon Modular System

+ Motor	Page	+ Sensor/Brake	Page	Overall length [mm] = Motor length + gearhead length + (sensor/brake) + assembly parts					
RE 35, 90 W	130			119.4	119.4	126.1	126.1	132.8	132.8
RE 35, 90 W	130	MR	420	130.8	130.8	137.5	137.5	144.2	144.0
RE 35, 90 W	130	HEDL 5540	429/431	140.1	140.1	146.8	146.8	153.5	153.5
RE 35, 90 W	130	DCT 22	438	137.5	137.5	144.2	144.2	150.9	150.9
RE 35, 90 W	130	AB 28	480	155.5	155.5	162.2	162.2	168.9	168.9
RE 35, 90 W	130	HEDS 5540/AB 28	429/480	172.7	172.7	179.4	179.4	186.1	186.1
EC-max 30, 40 W	224			90.2	90.2	96.9	96.9	103.6	103.6
EC-max 30, 40 W	224	MR	419	102.4	102.4	109.1	109.1	115.8	115.8
EC-max 30, 40 W	224	HEDL 5540	433	110.8	110.8	117.5	117.5	124.2	124.2
EC-max 30, 40 W	224	AB 20	478	125.8	125.8	132.5	132.5	139.2	139.2
EC-max 30, 40 W	224	HEDL 5540/AB 20	433/478	146.4	146.4	153.1	153.1	159.8	159.8
EC-max 30, 60 W	225			112.2	112.2	118.9	118.9	125.6	125.6
EC-max 30, 60 W	225	MR	419	124.4	124.4	131.1	131.1	137.8	137.8
EC-max 30, 60 W	225	HEDL 5540	433	132.8	132.8	139.5	139.5	146.2	146.2
EC-max 30, 60 W	225	AB 20	478	147.8	147.8	154.5	154.5	161.2	161.2
EC-max 30, 60 W	225	HEDL 5540/AB 20	433/478	168.4	168.4	175.1	175.1	181.8	181.8
EC-4pole 30, 100 W	233			95.2	95.2	101.9	101.9	108.6	108.6
EC-4pole 30, 100 W	233	16 EASY/Abs.	409/411	109.1	109.1	115.8	115.8	122.5	122.5
EC-4pole 30, 100 W	233	AEDL/HEDL	427/433	115.8	115.8	122.5	122.5	129.2	129.2
EC-4pole 30, 100 W	233	AB 20	478	131.4	131.4	138.1	138.1	144.8	144.8
EC-4pole 30, 100 W	233	AEDL/HEDL/AB 20	427/478	152.2	152.2	158.9	158.9	165.6	165.6
EC-4pole 30, 200 W	235			112.2	112.2	118.9	118.9	125.6	125.6
EC-4pole 30, 200 W	235	16 EASY/Abs.	409/411	126.1	126.1	132.8	132.8	139.5	139.5
EC-4pole 30, 200 W	235	HEDL 5540	433	132.8	132.8	139.5	139.5	146.2	146.2
EC-4pole 30, 200 W	235	AB 20	478	148.4	148.4	155.1	155.1	161.8	161.8
EC-4pole 30, 200 W	235	HEDL 5540/AB 20	433/478	169.2	169.2	175.9	175.9	182.6	182.6
MCD EPOS, 60 W	475			168.2	168.2	174.9	174.9	181.6	181.6
MCD EPOS P, 60 W	475			168.2	168.2	174.9	174.9	181.6	181.6